

Allow the test panel and urine specimen to equilibrate to room temperature (15-30°C) prior to testing.

1. Bring the pouch to room temperature before opening it. Remove the cup from the sealed pouch and use it as soon as possible.
2. Pull tab to remove cap, collect specimen in the cup and secure cap by pressing down on all three corners.
3. Check the temperature label between 2 - 4 minutes after specimen collection. A green colour will appear to indicate the temperature of the urine specimen. The proper range for an unadulterated specimen is (32-38°C).
4. Check the cap for a tight seal, date and initial the security seal label, then place it over the cap.
5. Remove one key from the kit, place the cup on a flat surface, and push the key into the socket of the cup to begin the test. Start timer.
6. Remove the peel off label covering the test results and wait for the coloured line(s) to appear. The results should be read at 5 minutes.

Do not interpret results after 10 minutes.

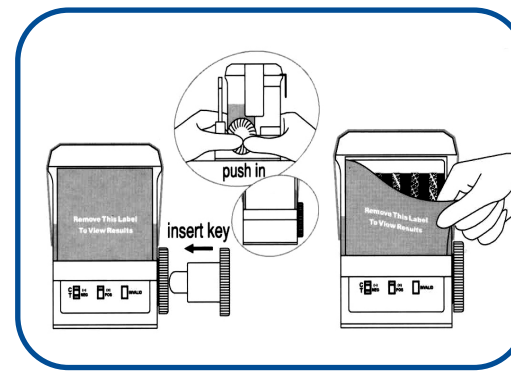
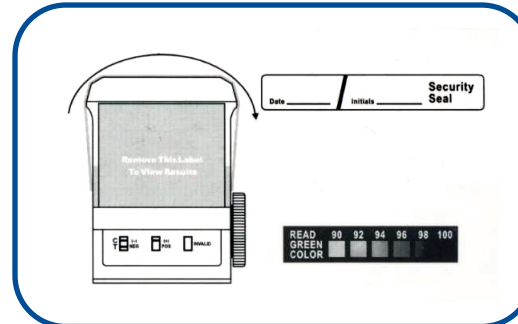
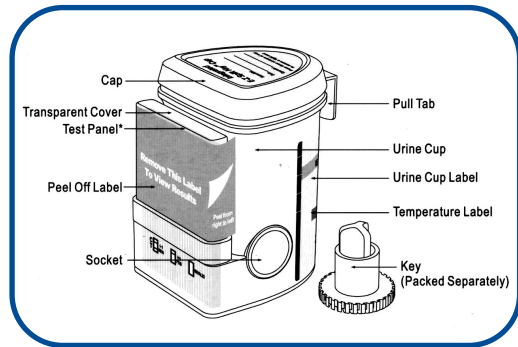

Cut-off Detection Times*
ng/ml (approximate)

AMP amphetamine	1000	1-3 days
BAR barbiturates	300	2-10 days
BUP buprenorphine	10	2-3 days
BZO benzodiazepines	300	1-6 days
COC cocaine	300	2-7 days
EDDP methadone metabolite	100	2-3 days
MET methamphetamine	1000	3-5 days
MTD methadone	300	1-4 days
OPI opiates	300 2000	2-4 days
PCP phencyclidine	25	7-14 days
PPX propoxyphene	300	1-3 days
THC thc / cannabis	50	14-84 days single use 1-3 days

LINE INTENSITIES AND WIDTH MAY VARY

ANY EVIDENCE OF A TEST LINE IN THE TEST REGION SHOULD BE CONSIDERED A NEGATIVE

NEGATIVE:* A coloured line in the control line region (C) and a coloured line in the test line region (T) for a specific drug indicate a negative result. This indicates that the drug concentration in the urine specimen is below the designated cut-off level for that specific drug.

***NOTE:** *The shade of colour in the test region (T) may vary, but it should be considered negative whenever there is even a faint coloured line.*

POSITIVE: A coloured line in the control line region (C) but no line in the test line region (T) for a specific drug indicates a positive result. This indicates that the drug concentration in the urine specimen exceeds the designated cut-off for that specific drug.

INVALID: Control line fails to appear. Insufficient specimen volume or incorrect procedural techniques are the most likely reasons for control line failure. Review the procedure and repeat the test using a new test. If the problem persists, discontinue using the lot immediately and contact Quantum Diagnostics.

Examples of valid results

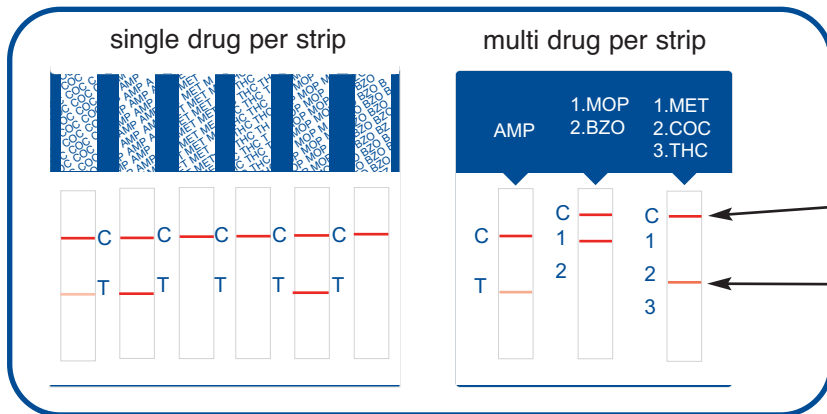

The examples above show **positive** results for:
Benzodiazepines (BZO) + Methamphetamine (MET) + Marijuana (THC)

Examples of invalid results

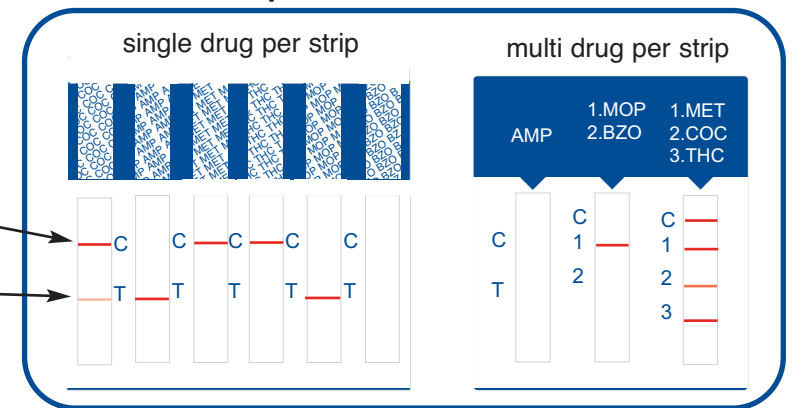

The examples above show **invalid** results for:
Amphetamine (AMP) + Opiates (MOP) + Benzodiazepines (BZO)

In the event of an invalid test, repeat with a fresh test cup.