

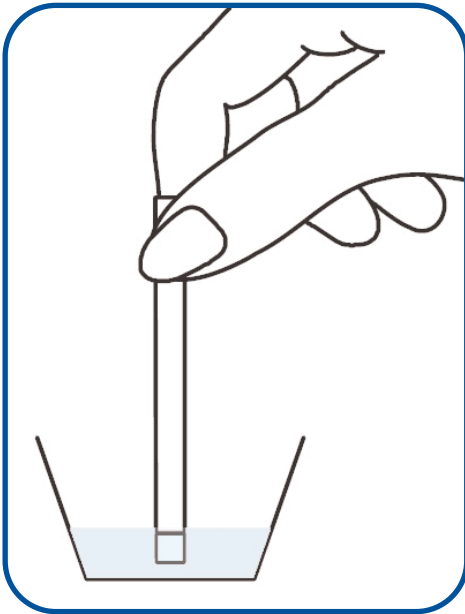

## Alcohol Saliva Test Step by Step Guide



Allow the test strip, specimens and/or controls to equilibrate to room temperature (15-27°C) prior to testing.

Do not place anything in the mouth for 15 minutes before beginning the test. This includes nonalcoholic drinks, tobacco products, coffee, breath mints, food, etc.

1. Bring the pouch to room temperature before opening it. Remove the test strip from the sealed pouch and use it as soon as possible after observing the reaction pad on the end of the test strip. The reaction pad should have a light cream colour.

**Do not use the test strip if the reaction pad has a blue colour before the saliva specimen is applied or is otherwise discoloured.**

2. Saturate the reaction pad with saliva from the collection cup or by applying saliva directly to the reaction pad. Saturating the reaction pad usually takes 6-8 seconds. Start the timer immediately after saturating the reaction pad with saliva.

**Note:** For hygienic and sanitary reasons, placing the test strip in the mouth is not recommended.

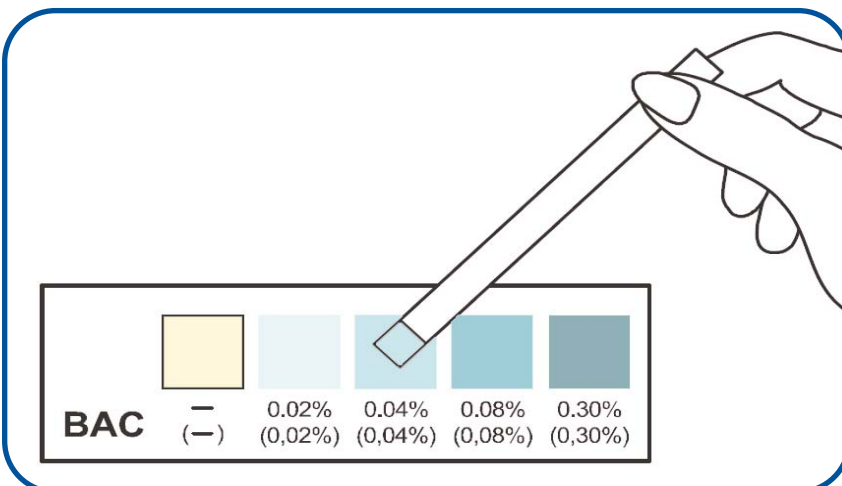
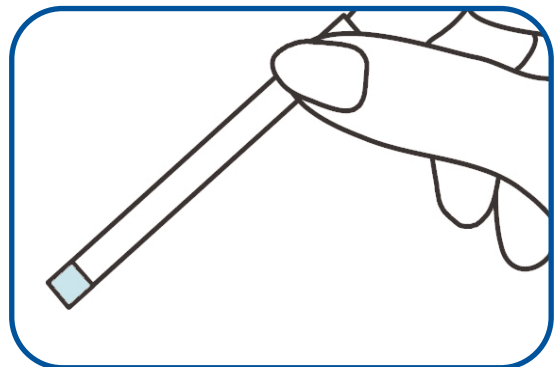

3. Read results at 2 minutes by visually comparing the colour of the reaction pad to the corresponding colour blocks printed on the pouch to determine the relative blood alcohol concentration.

**Do not interpret the result after 3 minutes.**